

# Sheeting & Slitter Station for Webtron 650 & 750

## Sheeting and Slitter Station Components

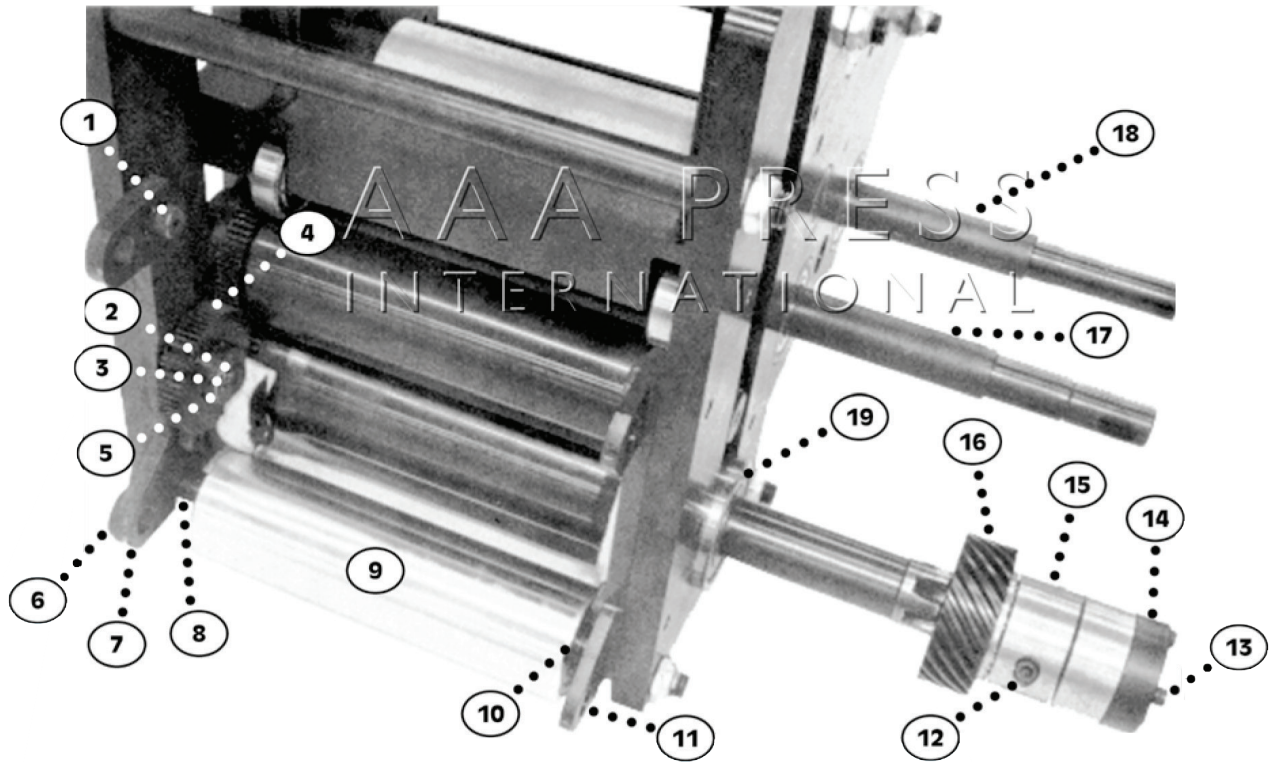

Reference #	Part #	Part Description
1	26-4603	Shoulder Screw - 3/8 x 1/2" Stacker Bracket (2 required)
2	7280	Stud - Intermediate Gear Includes 3 BHCS (1 required)
3	13-4015	Intermediate Gear Washer (2 required)
4 A	9424	Intermediate Gear 1/8CP 64T 20 P.A.
4 B	8299	Intermediate Gear 1/8CP 64T 14.5 P.A.
4 C	9424	Intermediate Gear /8CP 64T 20 P.A.
4 D	8299	Intermediate Gear 1/8CP 64T 14.5 P.A.
4 E	7225	Intermediate Gear 32DP 80T 14.5 P.A.
4 I	6364	Intermediate Gear 1/16CP 126T 14.5 P.A.
4 J	9511	Intermediate Gear 1/16CP 128T 14.5 P.A.
5	44-4020	Snap Ring - Stud Intermediate Gear
6	7243	Shim
7 A	7223	Outboard Stacker Bracket 2DP 1/8CP 63T - Webtron 650
7 B	7250	Outboard Stacker Bracket 1/8CP 64T - Webtron 650
8	6943	Idler Shaft

Reference #	Part #	Part Description
9	6918	Idler only - No Bearings
10	44-4027	Snap Ring
11 A	7217	Inboard Stacker Bracket 32DP 1/8CP 63T - Webtron 650
11 B	7287	Inboard Stacker Bracket 1/8CP 64T - Webtron 650
11 C	201-0226	Inboard Stacker Bracket 32 DP 1/8-64T
12	20-4405	Socket Head Cap Screw 1/4-20 x 3/4"
13	20-4037	Socket Head Cap Screw 10-24 x 1"
14	6933	Cap
15	6932	Brass Spline
16	6928	Helical Gear - Lower
17 A	6703	Pull Roll 32DP 1/8CP 63T - Webtron 650
17 B	6733	Pull Roll 1/8CP 64T - Webtron 650
17 C	301-0568	Pull Roll 1/8-64T - Webtron 750
17 D	301-0162	Pull Roll 32 DP 1/8-63T - Webtron 750
18	N6732	Slitter Roll
19	10-4004	Bearing - Lower Base Roll (3 required)

(Continued on the next page)

# Sheeting & Slitter Station for Webtron 650 & 750

## Sheeting and Slitter Station Components (Continued from previous page)

Part #	Part Description
6713	Dovetail - Webtron 650
10-4003	Bearing - Idler Assy (For #6703, #6733 & #6732) (2 required)
10-4017	Bearing - Jack Shaft (For #6703, #6733 & #6732)
10-4050	Bearing - Rear SBR & LBR - Webtron 750
11-4024	Bearing - Intermediate Gear (1 required)

Part #	Part Description
15-4039	Brass Oilite for Dovetail
29-4055	6-32 x 1/4" F.H.C.S. (3 required)
44-4020	Snap Ring (1 required)
201-0446	Inner Dovetail Bracket - Webtron 750
201-0447	Outer Dovetail Bracket - Webtron 750

